

RESIBLOCK

PERMANENT PAVING SOLUTIONS

RESIBLOCK '22'

APPLICATION SUMMARY

- 1 Ensure that steps 1,2,3 & 4 are completed the same day.
- 2 Following final compaction, sweep the area thoroughly to remove surplus sand. Ensure that the jointing sand has been fully removed from the chamfer. Ensure both sand and paver are completely dry.
- 3 RESIBLOCK '22' is not much thicker than water and is easily applied by utilising a watering can with a rose attached. Accurate spread rates are essential e.g. 100 x 200mm Concrete Block Paving (CBP) 2m²/litre. For best results fill your watering can with RESIBLOCK '22', pour out 1 litre evenly over 2m², being a manageable amount to squeegee.
- 4 Having applied Resiblock to the pavers, squeegee off the surface starting at the top and always working towards you. Pull RESIBLOCK '22' off the surface, it will pool in the chamfers/joints and will be absorbed by the kiln dried jointing sand.

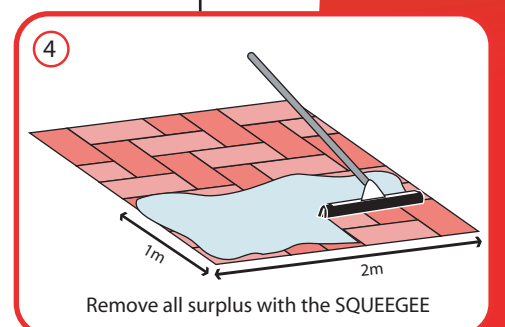
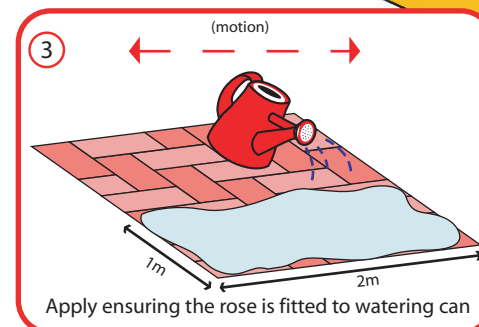
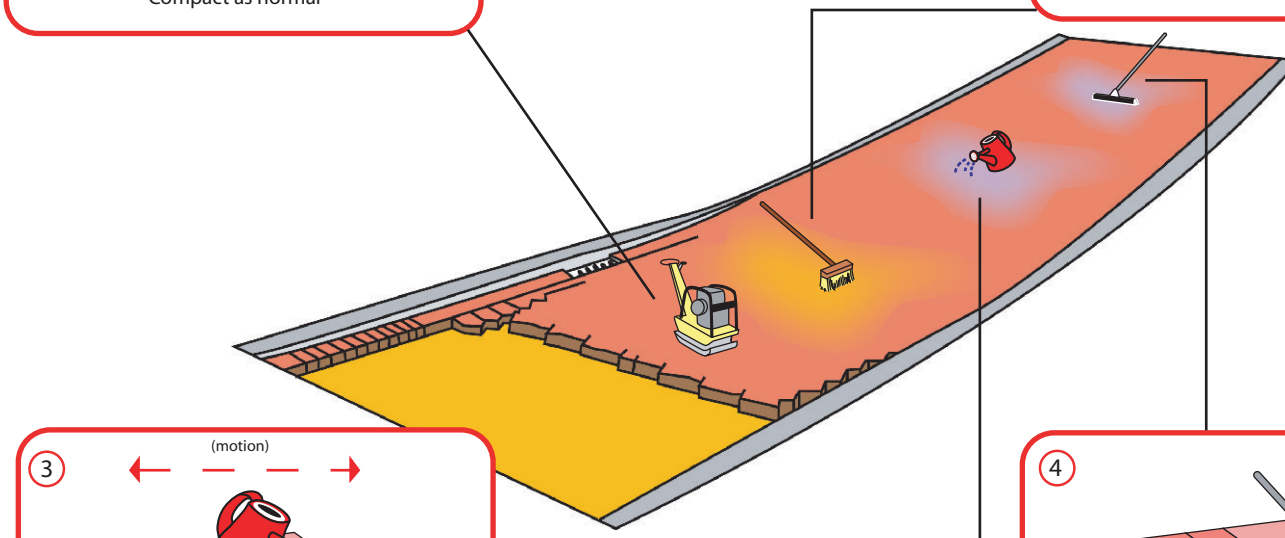
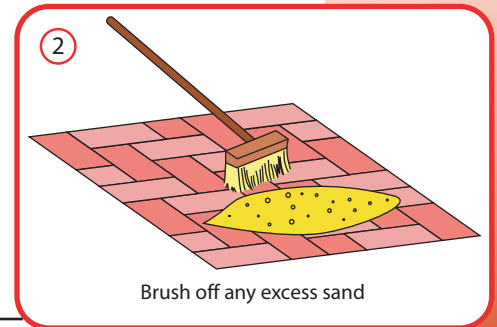
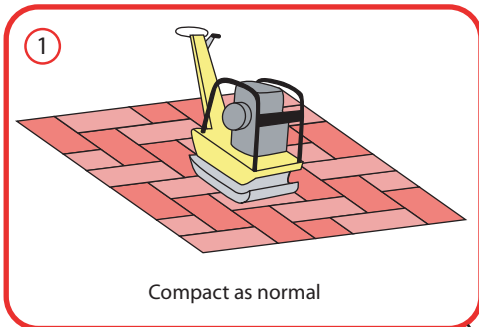

See reverse for further summary notes

RESIBLOCK '22'

APPLICATION SUMMARY

On new projects, ensure paving is sealed with RESIBLOCK '22' simultaneously with pavement construction, on a daily basis. **DO NOT WAIT** until project is complete.

1. Make sure the surface and jointing sand are **THOROUGHLY DRY** and free from dirt.
2. Ensure that RESIBLOCK '22' is applied when there is no risk of rain within the next 8 hours.
3. Do not apply in extremes of temperature (below 3⁰ C or above 30⁰ C).
4. Ensure paving is thoroughly swept and that no jointing sand remains in the chamfers of the pavers.
5. Apply to surface using a watering can (with the rose attached) and remove **ALL** surplus with a RESIBLOCK SQUEEGEE.
6. Accurate application rates are essential to ensure full joint stabilisation e.g. 100 x 200mm CBP 2m²/litre. For other dimensions/types of paving contact Resiblock's Technical Department.
7. Two coats are recommended to prevent fuel Further advice from Resiblock's Technical Department should be obtained. **ONE COAT ONLY ON CLAY PAVERS.**
8. Avoid walking on the sealed area until the face of the paver is dry to the touch. Do not drive motor vehicles on the surface for 24 hours.
9. ALWAYS WEAR PROTECTIVE GLOVES AND GOGGLES. NO SMOKING. WEAR A MASK WHEN WORKING IN CONFINED AREAS. Please refer to current MSDS.
10. All uncured sealant spillages/splashes and tools should be cleaned immediately using **RESIBLOCK RESICLEAN.**

FOR FURTHER INFORMATION OR TECHNICAL ASSISTANCE CONTACT RESIBLOCK LTD

Resiblock Ltd
Resiblock House
Archers Fields Close
Basildon
Essex, SS13 1DW

Tel: (+44) 01268 273344 Fax: (+44) 01268 273355
email: mail@resiblock.com
www.resiblock.com



www.paving.org
Associate Members of Interpave Ltd



Sponsors of
The Institute of Highway Incorporated Engineers

Please note this summary is offered as a general guide only and does not replace the current published Application Guidelines which must be read prior to application together with the current Material Safety Data Sheet.